

Replacement Tread Installation Guide



Tools Needed for Installation



Pencil

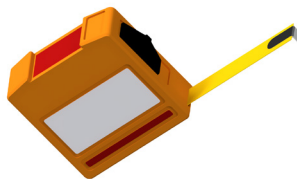

Tape Measure



Straight Edge



Sawzall/Saw



Router (Optional)



Miter Saw



Brad Nailer



Construction Adhesive
(PL Premium Recommended)

Things to Know Before You Get Started

- Read over the provided material prior to the start of your installation
- It is important to have a consistent rise and run from the first step to the last step. Please take into consideration the thickness of the tread and its impact on the rise measurement when preparing your stairs.



YouTube
Visit our YouTube channel to
watch helpful installation videos
[youtube.com/viewrail](https://www.youtube.com/viewrail)

Replacement Tread Installation Steps



- The first thing to do is to prep your stairs. If you are redoing carpeted stairs you will want to remove the carpet and sand/clean the surface from any debris, dust, or staples
- If you are putting replacement treads over a construction tread, make sure debris is removed and the surface is clean

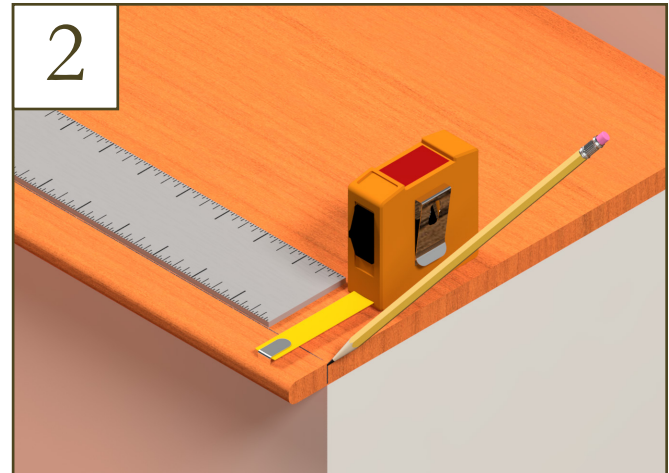

- Measure and mark the nosing on each stair tread
- You will want to make a mark the length of the tread



- Using a circular saw or sawzall, cut the length of your nosing off
- You can use a flush cutting saw near the edges for a more controlled cut
- Remove all nosing
- Attach your risers if this is part of your project before proceeding



- Some StairSupplies replacement treads have a rounded underside where the tread nosing connects to the body
- If the underside of your tread does not have a rounded seam, then move on to **Step 5**
- The rounded seam gives the seam more glue surface area and creates a stronger nosing
- Use a sawzall to cut the surface front edge at an angle so the tread rounding fits well
- Or, use a hand router to round the surface front edge

Replacement Tread Installation Steps (Continued)

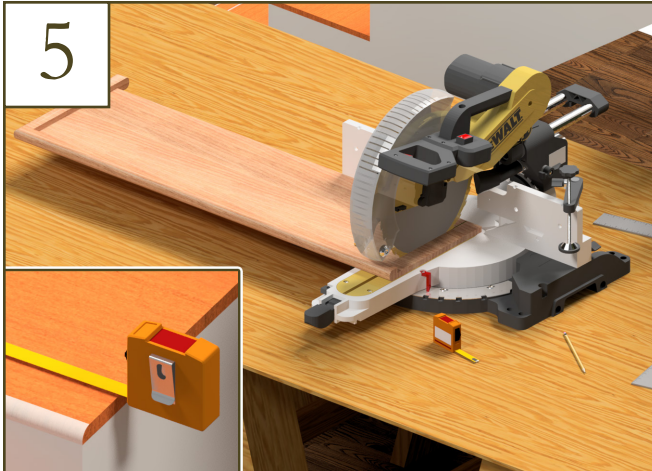

- Take a measurement of the tread size needed
- Mark and cut the replacement tread to match
- Individually measure each surface before cutting the next tread
- Dry fit your cut treads into place to make sure it is a tight fit. Adjust if needed

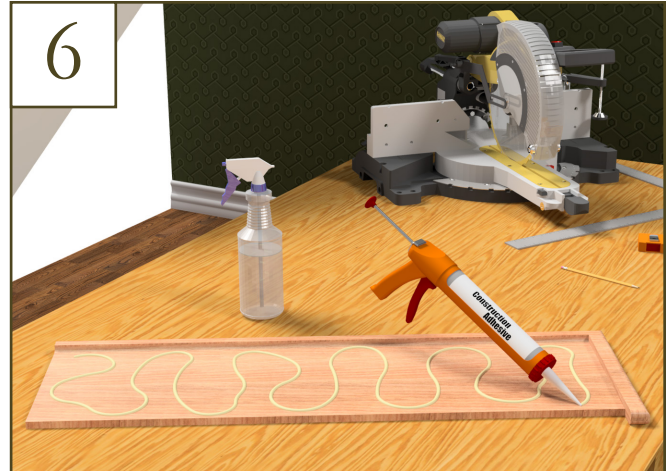

- Make sure the underside of the tread you will be mounting is free from dust or debris
- Using construction adhesive, snake a line across the length of the tread underside

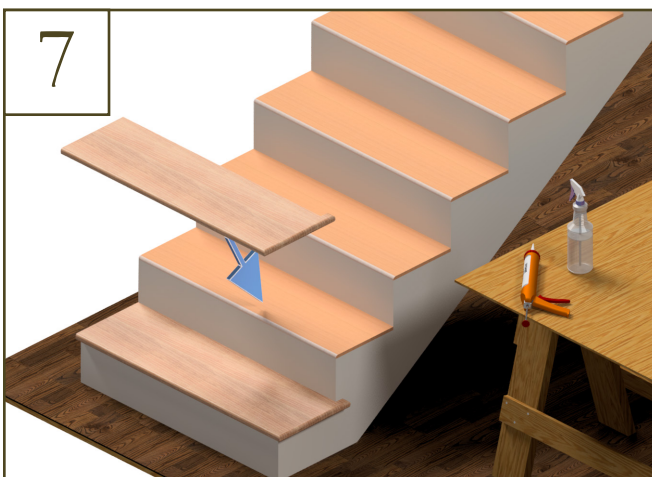

- Make sure the surface you will be mounting the tread on is free from dust or debris
- Put the replacement tread on the prepared mounting surface and push firmly into place



- Using 2" finish pins, pin the four corners into the substructure. This will help secure the tread while the adhesive cures
- Putty and finish as needed, if desired
- Repeat the fastening process for every step

Congratulations! You're done with this section.

We'd love to see your work! Snap a few pics with your phone and send them to pictures@stairsupplies.com
Thank you for choosing StairSupplies. Enjoy your new installation!